

Bliss Box Former



FIGURE 14-8
BLISS COMPRESSION CHAMBER
DOUBLE LINKAGE ASSEMBLY

ITEM	PART NO.	DESCRIPTION	QTY.
1	0050900R/L	PLATE, COMPRESSION	1/1
2	0050800	UPRIGHT, COMPRESSION	4
9	0051200	7/16-20 CONNECTING ROD	2
10	0050700	BOX CLAMP TOGGLE SHAFT	4
11	0020100	LEVER, BOX CLAMP TOGGLE	12
12	0020001	LINK, BOX CLAMP (THD)	8
13	0020000	LINK, BOX CLAMP	8
14	0013700R	YOKE, BOX END CLAMP	2
15	0013700L	YOKE, BOX END CLAMP	2
16	0019801	ROD	2
17	0013800	KNOB, BOX CLAMP	2
101	8036900	7/16 LOCK WASHER	32
102	8012200	7/16-14 HEX BOLT X 2 1/4	2
103	0501000	7/16 ROD END	4
104	1500100	1 DIA WASHER	4
105	8036900	7/16 LOCK WASHER	2
106	8024600	7/16-14 HEX NUT	2
116	0501202	7/8 FLANGE BEARING	8
117	8001600	5/16-18 CARRIAGE BOLT X 2	16
119	8024400	5/16-18 HEX NUT	16
120	8028800	3/8-16 OVAL PT SET SCR X 3/8	12
121	0700900	3/32 X 1 COTTER PIN	4
122	0600100	3/8 C 1 1/8 CLEVIS PIN	4
123	8008500	5/16-18 HEX BOLT X 1 1/2	16
125	0204400	BUSHING	16
126	8023200	3/8-24 HEX NUT	2
127	8028200	3/8-16 FLT PT SET SCREW X 3/8	2
128	8023300	7/16-20 HEX NUT	4



Bliss Box Former

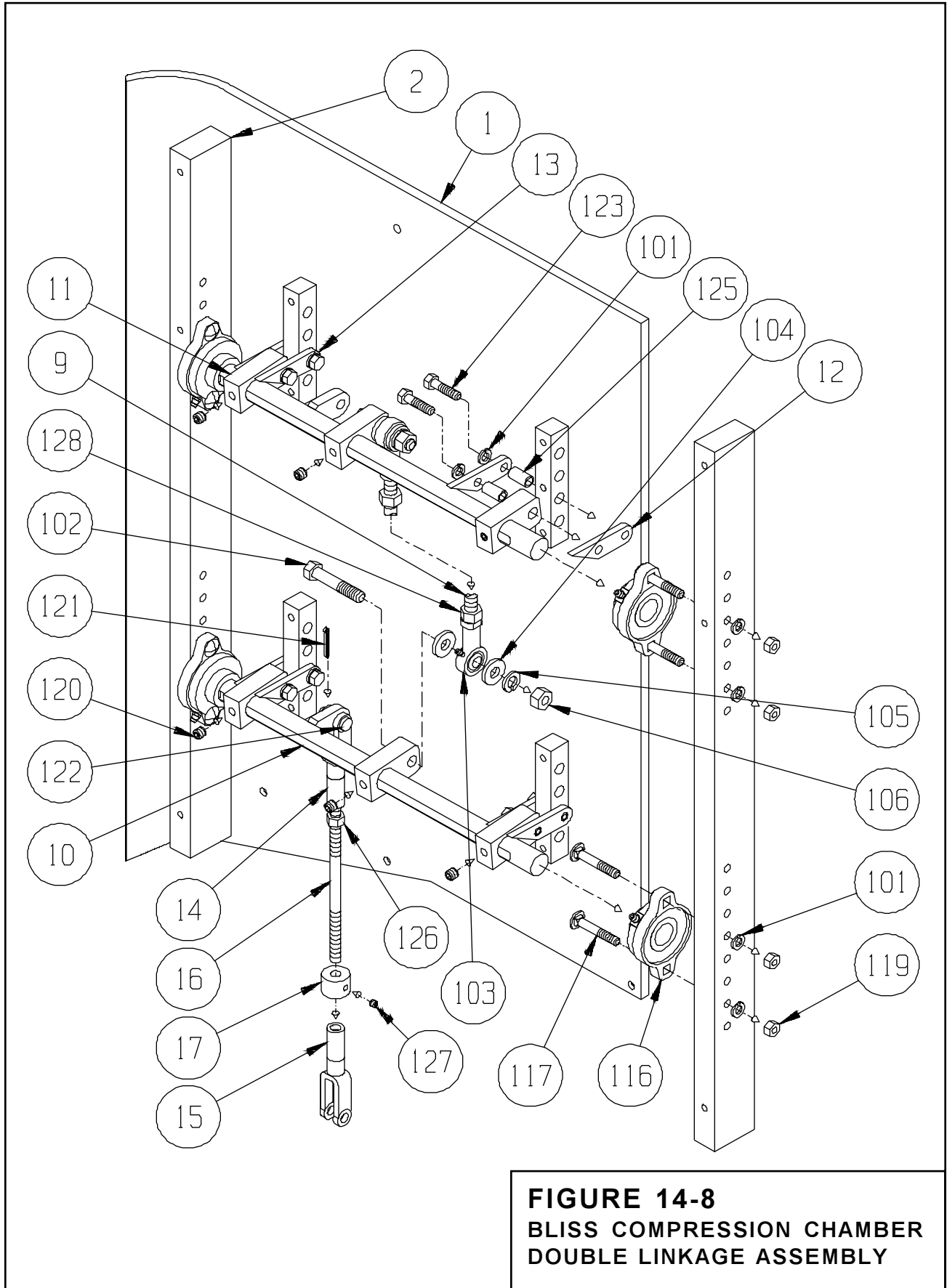

FIGURE 14-8
BLISS COMPRESSION CHAMBER
DOUBLE LINKAGE ASSEMBLY

Option Parts & Illustrations